



# JEEP GRAND CHEROKEE

## CHROME FRONT AIR DEFLECTOR



**(A1)** Chrome Air Deflector



**(A2)** Fasteners x 5



**(A3)** Bumpers x 5

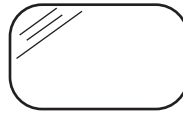

**(A4)** Anti-abrasion Film Pads x 5



**(A5)** Alcohol Wipes x 1

### A KIT CONTENTS



Phillips Screwdriver



Wash Tools

### B TOOLS REQUIRED



INSTALLED VIEW OF  
FRONT AIR DEFLECTOR

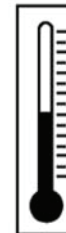

97°F

35°C

68°F

20°C



### APPLICATION:

#### IMPORTANT NOTICE

Prior to installation, check the entire kit for possible damage or defects.

**IF PARTS ARE DAMAGED OR CONTAIN DEFECTS DO NOT INSTALL.  
YOU MUST RETURN THE COMPLETE KIT IF YOU WISH TO MAKE A WARRANTY CLAIM.**



# JEEP GRAND CHEROKEE

## CHROME FRONT AIR DEFLECTOR

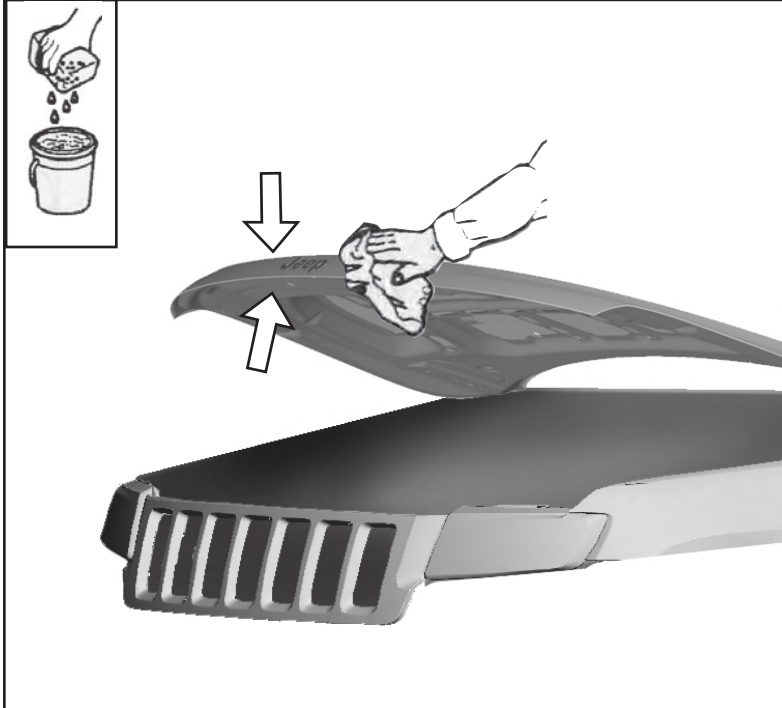

**1** WASH TOP AND BOTTOM SIDES OF THE HOOD SURFACE AND DRY WITH CLEAN CLOTH.

BUMPER **A3** PLACEMENT INDICATED BY CIRCULAR MARKINGS ON BACK OF AIR DEFLECTOR. (5x)

CLEAN BACK OF AIR DEFLECTOR SURFACE LOCALLY WITH THE ALCOHOL PAD OR A CLEAN CLOTH USING ISOPROPYL ALCOHOL; 70% MINIMUM. INSTALL BUMPERS AFTER ALCOHOL HAS COMPLETELY EVAPORATED.

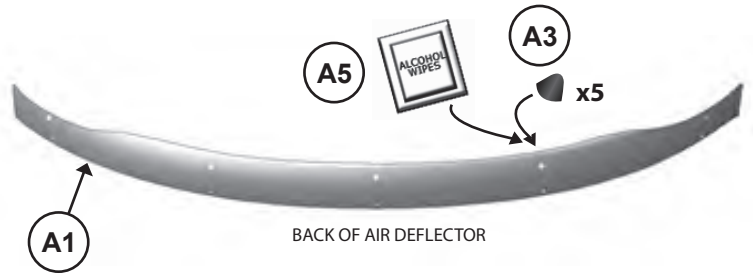

**2**

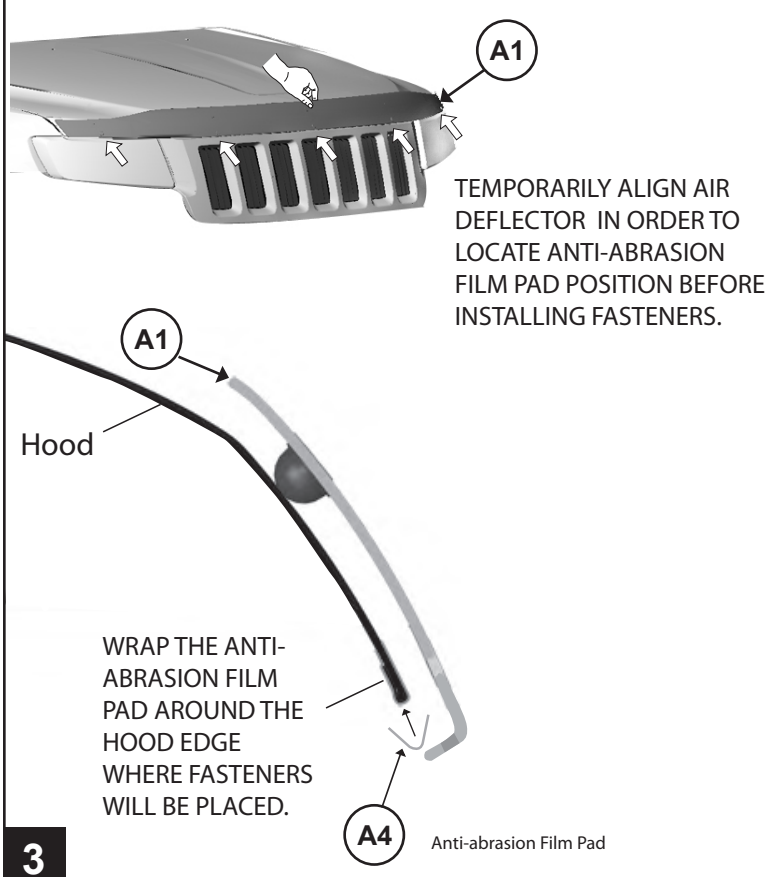

TEMPORARILY ALIGN AIR DEFLECTOR IN ORDER TO LOCATE ANTI-ABRASION FILM PAD POSITION BEFORE INSTALLING FASTENERS.

WRAP THE ANTI-ABRASION FILM PAD AROUND THE HOOD EDGE WHERE FASTENERS WILL BE PLACED.

**3**

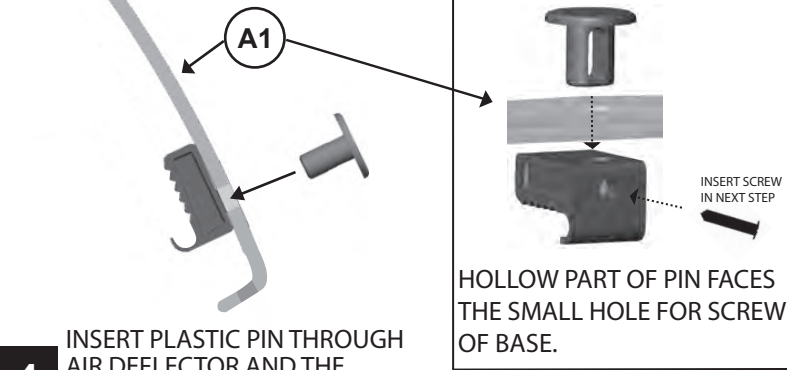

**4** INSERT PLASTIC PIN THROUGH AIR DEFLECTOR AND THE FASTENER BASE. (X5)

HOLLOW PART OF PIN FACES THE SMALL HOLE FOR SCREW OF BASE.

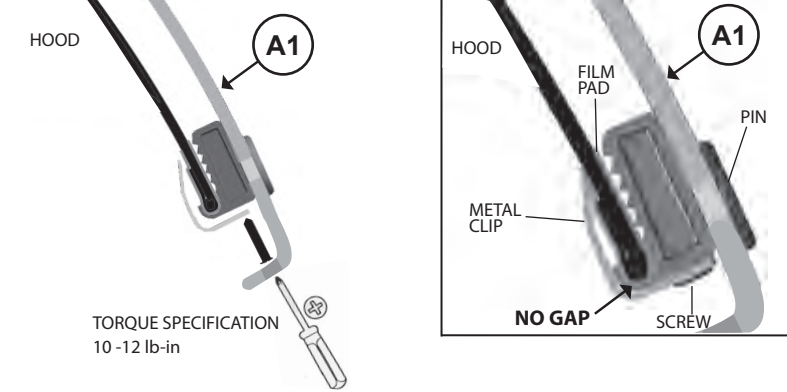

TORQUE SPECIFICATION 10 -12 lb-in

**5**

AFTER DEFLECTOR IS PROPERLY ALIGNED, SECURE AIR DEFLECTOR TO THE HOOD USING METAL CLIPS AND SCREWS. (X5)